

# GULF COAST WOODTURNER

December 2008



## President's Corner

We are rapidly approaching the Christmas and New Year Holidays and I wish everyone a very safe, happy, and healthy holiday season. As we wrap up 2008 its an opportune time to look back on accomplishments and look forward to the things we can do even better, for ourselves and others, during the coming year. For GCWA 2008 has been fairly successful year. We've accomplished a lot and we set in place plans for a great 2009.

Along with a new year we'll see some new faces and have renewed opportunities for everyone to get more involved in making things happen. At the top of the change list is **Reggie Keith** who is turning over the reins of the monthly raffles to **Delia Spicer**. Reggie has been working the raffle several years and we deeply appreciate his efforts and commitment. When you see Reggie please give him a hearty Thank You and let's all welcome Delia to her new role.

At the November general meeting we held a vote on a Board recommendation to increase GCWA dues to \$25 per year. The vote was overwhelmingly in support of the increase. The Board also gained some valuable insights from the membership to work with as we plan out activities for 2009 and beyond. Speaking of planning the Board had a very long December meeting while we grappled with a budget for calendar year 2009. We've made a tremendous amount of progress and we fully expect to have the budget formally accepted at the January Board meeting.

Work has already started for the 2009 GCWA Spring Retreat. I am pleased to announce that **Andy Chen** has accepted the role of Program Chair for this year's event. Andy has a good deal of turning experience, he is well known around the club, and has a sound business background all which will be beneficial in this role. Andy will be teamed up with **Tom Enloe**. Tom will serve as the Board point of contact and will support Andy in this

GCWA Web Sites:

[Http://www.gulfcoastwoodturners.org](http://www.gulfcoastwoodturners.org)

[Http://jhanley.us](http://jhanley.us)

important area. Tom has provided significant support for the program chairs of the 2007 and 2008 events. If you have any ideas on what you'd like to have included in the 2009 program, or something to eliminate, please contact Andy or Tom.

While we're making progress in staffing some of the Retreat leadership roles (there are still opportunities to get involved!) we are faced with a more pressing need for someone to step into an on-going role for the club. Our Newsletter Editor, **David Morley**, will be leaving that post after completion of this issue of the newsletter. If you have basic computer skills and an interest in making a big contribution to the success of GCWA we need to hear from you, asap. David has held the post of Newsletter Editor for the past year. We are very grateful for the time and effort David has put into the newsletter all these months (and for putting up with my late arriving articles). Thank You, David for your contribution to GCWA. Now it's time for someone else to stand up and be counted. If you like having a club newsletter you might think about the fact that someone has to do the work. Remember, it's your club, so get involved.

Well, I hope everyone has enjoyed the fall season and has had time to catch up on all the turnings to provide great Christmas gifts. The cooler nights are upon us and we can now all hibernate into our shops for the winter and get on with our creative work at the late.

***Merry Christmas and Best Wishes for a Healthy, Happy and Safe 2009!***

*george*

December Meeting  
December 20, 2008

Bayland Community Center  
6400 Bissonnet  
Houston 77074

## CLASSIFIED ADS

Woodturning related items of interest to GCWA Members listed as a free service.

Hands-on woodturning lessons by Jim Keller at Foxfire Studios. You pick the subject; learn with my tools or yours. Oneway 2430 and Jet 1642 lathes avail. Rates- 8 hour lesson, one person \$135.00, lunch included, add a second person for \$75.00. 4 hour lesson, one person \$65.00, two for \$40.00. Call 281-467-2866 for info.

## NEEDED: TOPS, TOPS and MORE TOPS

Jan 17, 09 is the day that the Houston Arboretum will be celebrating Arbor Day and once again they have invited GCWA to demonstrate for their visitors. As part of the demonstrating we turn spinning tops to give to the children that come by and see us and every year we give out over 100 tops. That is how you can help. We need tops because we can not turn that many, that fast. Please bring any tops that you could spare to the Dec meeting and give them to **Greg Gonsalves** or **Don Fluker**. Or bring them to the Arboretum and even turn one while there. This is the day of our Jan meeting so stop by after the meeting and turn a top or say hello

## Ornament Exchange

Once again Christmas is almost here and it is time for our annual Christmas tree ornament exchange. The rules are simple; you turn an ornament, or several, and put them on the "tree". After everyone has placed their ornaments on the tree, participants will draw numbers out of a hat. If you bring more than one ornament there will be additional rounds of drawing numbers. Everyone that brings an ornament will get a first round pick. It is a good idea to sign or attach a tag to the hanging string that tells who turned the ornament and what kind of wood it is. Several years from now you might want to know. This is a great way to share one of your turnings and the spirit of giving. **Judging:** . *Please do not bring an ornament for the regular Show and Tell as they will not be accepted.* We only want ornaments that are for the exchange. There will be 1st, 2nd, and 3rd place awards. Honorable Mention and Best of Show if the judges think it is justified. **Ornaments will be judged as one group;** no beginner, no intermediate, no advanced, no segmented and no enhanced categories. Only ornaments on the exchange trees will be eligible for judging.

## Toolswap this Month

One of the popular activities of some of our meetings is a "Turning Toolswap". We are going to do it again at the December meeting. Those of you who didn't bring your "stuff," to the last Toolswap, get it all together, now that you know how it works. If you have any wood, turning tools and turning sundries that you want to **SELL or TRADE**, please bring them to the December meeting. Start digging out all those seldom or never used items that are collecting dust. It could be just the tool someone else "needs". There will be tables set up to display all of your items. **Please have all tools marked with your name and a price.**

## MEMBERSHIP

Four new members joined GCWA in November. Let's welcome

**Jeremy Grubb  
Linda Hamil-Ross  
Rich Duffy  
Monique Adams**

## Our Addiction

By Steve LeGrue

**W**hat is it about woodturning? It starts with a pen class, or a fascination with the vessel, or the need for a set of legs, and the next thing you know that is all you are doing. Your garage or yard fills up with logs, and you can be found knee deep in shavings. I was a weekend box maker before I discovered woodturning, and it changed my life.

Woodturning involves all of the senses in an immediate and tactile way: You hear the hiss of the tool cutting as you see the wood curl away. Touch guides the bevel against the wood. You have the taste of the dust in your mouth, the smell of fresh cut timber in your nose. It brings you into the here and now. I've taught hundreds of students over 15 years, and almost all are drawn to the immediacy of woodturning. You are touching the wood with the tool and it is changing: Dynamic, sculptural, subtractive. And best of all, if you screw up a detail or have a catch that changes the shape, who cares? It was going to look like that, now it looks like this! Forgiveness. At the worst you have a piece of floor art, a product that can lead to design opportunities.

The attraction of all woodworking is the beauty of the wood. This is especially true in woodturning, because we use the unusable: the burl, the crotch, the butt. This is where the best figure lies, if you know how to unlock it. The wood that nobody wants, the stuff that doesn't even look like it will burn. We take it and soak it with superglue, [discover](#) a shape that the wood will allow us, clean out the bug poop and take it from the grave to [the gallery](#). [Firewood to Fine Art](#).

Enjoy your affliction.

## President's Challenge

By: George Kabacinski

**T**here is no President's Challenge for the December meeting. Getting on with the backlog of requests for turned Christmas gifts is challenging enough. At the December meeting we'll have our traditional Ornament Exchange. So be sure to bring an ornament for display on the tree and to be exchanged for an ornament created by a fellow club member.

The challenge for January, 2009 will be to come up with a turning based on an article in ***American Woodturner***. For those who may not know this is the journal produced by AAW. The Fall 2008 edition (Vol 23, No 3) carried an article by **Tim Heil**, titled 'Doorknob Upgrade' (pg 48). Read the article, head out to the workshop, and then show up with your version of a custom turned doorknob for the January President's Challenge. Just be careful if you decide to remove a doorknob from your house for parts ... your spouse may not take kindly to the idea! For those who may need an even greater challenge go for a perfectly matched set or a whole series for a specific room, or even the entire house!

By February we should be past the harsh Houston winter (what's that?). I expect folks will be back to wearing shorts and getting ready to plant their spring gardens, or at least thinking about it. So let's carry on with that as a theme and create 'something for the garden'. I'm thinking of turning a flower pot. What can you come up with that is garden related? Let's get into the spirit of the coming spring!

The next Exchange Challenge will be in March, 2009. While that's a ways off I wanted to put the challenge out and give everyone plenty of time to work on it. The item? A working time piece – this can be a wall clock, pocket watch, watch pendant, desk clock or whatever turns you on!

April will bring around the GCWA Picnic. For that event we've sort of started a tradition of having 'weird turnings' as a theme. So let's plan to build on that theme and come up with something way out there for April.

## DECEMBER DEMO

by Tom Enloe

**V**ISUALIZE – do you ever look at a log and wonder what is hiding inside. You know, “would this chunk of wood make a good vase or maybe a very nice toothpick”.

At the December meeting, Jim Keller will be helping us with our visualization! He will discuss possible forms and design options. This is intended to be a discussion to benefit all levels of woodturners and includes using crotch wood, negative space, heartwood versus sapwood, and the benefits of various grain orientations.

## LIBRARY CORNER

by Tom Enloe

**T**he library staff have completed an overhaul of the library and replaced all missing DVDs. In addition, several new DVDs have been added and a new label has been added to each disk boxes.

## SWAT News

by Tom Enloe

**I**n January, I will be attending the annual SWAT organization meeting and would appreciate your input.

One of the subjects may be a vote of going back to Waco or Temple. While Temple is a lot closer than Wichita Falls and Temple is a lot cheaper than Waco (it has been refurbished) – it has about the same attendance limit as before. So it will require an attendance limit of 500 turners rather than the approximately 570 members from the last couple of years.

## -- Call for Bowls --

By Lane Bradford

### Join Local Craftspeople and Artists for Houston's Fifth Annual Empty Bowls Event March 29, 2009

**I**t's that time again -- time to plan to set aside your time and talent early next year for making bowls to help feed those who are hungry in the Greater Houston area. The Houston Empty Bowls Committee, comprised of the craft and art community, the Houston Food Bank, Houston Center for Contemporary Craft, Lawndale Art Center, and Whole Foods Market invites ceramists, woodturners and woodworkers, hot and warm and cold glass artists, fiber artists, metal-smiths, painters and sculptors, artists of all kinds, to create and donate handmade bowls for Empty Bowls Houston 2009. All of us thank you for making bowls and thus, making Empty Bowls Houston a great success for four years running.

For the 2008 event, more than 100 artists contributed more than 1100 bowls and several hundred Houstonians purchased bowls. Whole Foods Market donated 5% of its sales from all area stores during its Community Giving Day. As a result, Empty Bowls Houston 2008 raised more than \$45,000 for the Houston Food Bank, who can turn that into an equivalent of more than \$360,000 worth of food for those in Houston, Harris County, and surrounding counties in need. Now it's time for a successful fifth.

Bring your donations to our **February** GCWA meeting. Any bowl or bowl-like object will be accepted, and bowls do not need to be functional (i.e. actually hold soup). For anyone wondering about size, think in terms of a bowl with a height from 2" - 4 in", diameter from 4"- 6", volume 1 1/2 cups to 3 cups.

Any questions or comments, please fire away. Thank all of you for your participation!

# NOVEMBER SHOW & TELL

Best of Show

**Eddie James**  
Segmented Oak & Purple Heart Bowl



## Advanced Category

**1st Place Gary Rock**  
Aspen Bowl



**2nd Place Larry Zarra**  
Oak Bowl



**3rd Place Doug Davis**  
Cocobolo Bowl



**Honorable Mention Dave Greenawalt**  
Box Elder Salad Set



## Intermediate Category

**1st Place- Tom Hamilton**  
Cherry Bowl



**2nd Place- Linda Bohl**  
Hackberry Bowl



**3rd Place- Tom Hamilton,** Mesquite Bowl



**Honorable Mention No Info Available**  
Corian Peppermill



## Beginner Category

**1st Place Jeremy Grubb**  
Purple Heart & Zebra Wood Table



**2nd Place Georgene Huckeba**  
Sycamore Goblets



**3rd Place Monique Adams**  
Paduak Pen



## Enhanced Category

**1st Place- Janice Levi**  
Mahogany Cornucopia



**2nd Place- John Van Domelen**  
Mesquite Bowl



**3rd Place Ronnie Hubbell**  
Maple Platter



**Honorable Mention Bruno Wesolek**  
Ebonized Holly Boxes



## Segmented Category

**1st Place- Bill Berry**  
Mahogany & Black Palm Bowl



**2nd Place- Dennis Weber**  
Zebrawood Rattle



**3rd Place Steve LeGrue**  
Cocobolo & Maple Christmas Ornament



Gallery Photos by Paul Millo

**President's Challenge** (A monthly challenge to promote creativity)

**This month's challenge: Collaborative piece pairing an Advanced Turner with a newer one.**

**1st Place- Bill Tilson & Stacie Grange, Pecan & other decorative wood bowl**



**2nd Place- Bill Berry & Linda Bohl, Spalted Sycamore Assemblage**



**3rd Place- Bruno We-solek & Frank Campbell Unknown Wood Freeform**



**Demonstration**

Steve LeGrue demonstrated turning basic Christmas ornaments



Steve LeGrue demonstrated how to make basic, but elegant Christmas ornaments



Steve turned several basic forms and then used coloring and other enhancements



Steve worked quickly, but explained each step carefully



Finished ornaments!

**Faces in the Crowd**



It seems as if a good crowd always shows up when we hold meetings at Clark's Hardwood Lumber. Is that because of the spacious meeting space or the free coffee & donuts?



GCWA turners demonstrated a wide range of creativity at November's meeting, But then again, that's not at all unusual--we've got some terrific turners in this club!



Tom Hamilton (r) talked about his Intermediate Category award-winning piece. Bill Berry (l) is our club's Show and Tell Master of Ceremonies



Gary Rock talked about his Advanced Category First Place piece made from Aspen as Bill Berry gives it a close inspection.



Stacie Grange and Bill Tilson teamed up to blow away the competition in the President's Award Challenge! November's challenge was a collaborative piece teaming relatively new turner with an experienced one.



Robert Frost (left) and Bill Metzger (right) were the judges for November's Show & Tell entries.

## Scheduled Meetings & Events

*Meeting dates and locations are subject to change.*

**December 20, 2008 ~ GCWA General Meeting ~**  
**Location:** Harris County Bayland Community Center ~  
 6400 Bissonnet, Houston 77074  
**President's Challenge:** Ornament Exchange

**January 5, 2009 ~ Board Meeting ~** Location TBD

**January 17, 2009 ~ GCWA General Meeting ~**  
**Location:** University of Houston Main Campus ~  
 Keeland Discovery

**President's Challenge:** Custom Turned Doorknob

**February 9, 2009 ~ Board Meeting ~** Loc TBD ~

**February 16, 2009 ~ GCWA General Meeting ~**  
**Location:** Foxfire Studios ~ 105 South 5th Street,  
 Richmond, TX ([map](#))  
**Demo:** Multi-axis Turning

**March 9, 2009 ~ Board Meeting ~** Location TBD ~

**March 21, 2009 ~ GCWA General Meeting ~**  
**Location:** Memorial Lutheran Schools ~ 5800 Wes-  
 theimer, Houston, TX  
**President's Exchange Challenge:** A working time-  
 piece--wall clock, pocket watch, watch pendant,  
 desk clock, other timepiece.

**April 6, 2009 ~ Board Meeting ~** Location TBD ~

**April 18, 2009 ~ GCWA Picnic ~ 9:00AM - Noon**  
**Location:** Bear Creek Park

**May 16-17, 2009 ~ GCWA Spring Retreat ~**  
**8:00AM - 4:00PM**

**Location:** Montgomery County Fairgrounds ([map](#))  
 (Additional information to follow)

## December Meeting

Bayland Park Community Center  
 6400 Bissonnet  
 Houston 77074

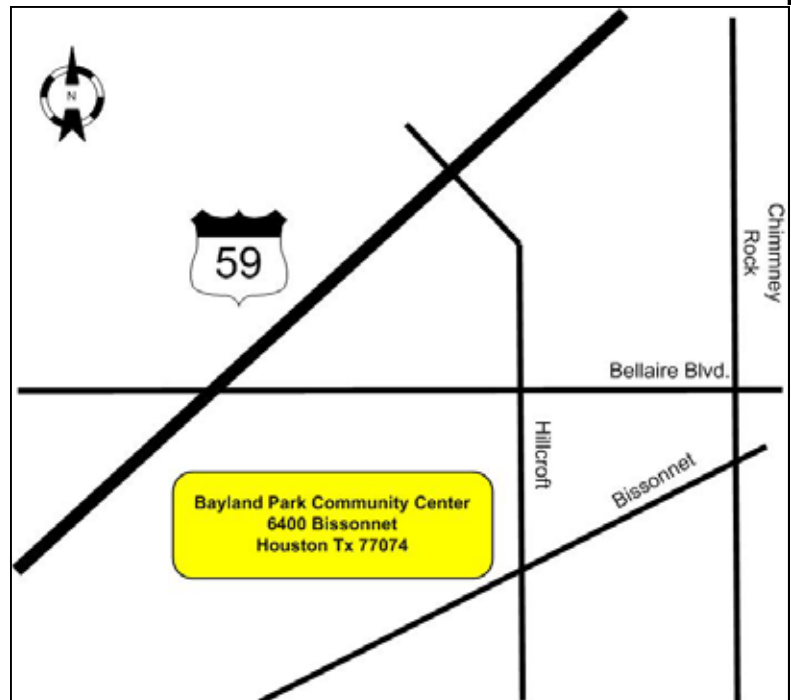

## December Meeting Program

Tom Enloe and Jim Keller will discuss finding the best that is contained in a piece of wood.

## EXECUTIVE COMMITTEE

George Kabacinski - President  
 (832) 349-3006  
[gkabacinski@gmail.com](mailto:gkabacinski@gmail.com)

Tom Enloe - Past President/Program  
 Chair/Librarian/SWAT Representa-  
 tive (832) 229-4404  
[tomtom@houston.rr.com](mailto:tomtom@houston.rr.com)

Lane Bradford - Vice President  
 (281) 494-0396  
[LaneBradford@eaton.com](mailto:LaneBradford@eaton.com)  
 (281) 444-7993

Mack DeBose - Treasurer  
 (281) 444-7993  
[Lmdebose@swbell.net](mailto:Lmdebose@swbell.net)

Dave Barziza - Board Member/Judging  
 (713) 661-5941

Clyde Collier - Board Member  
 (281) 487-2143  
[clutha2143@sbcglobal.net](mailto:clutha2143@sbcglobal.net)

Steve Legrue - Board Member  
 (832) 496-0040 cell  
 (713) 981-9228 work

John Van Domelen - Secretary/  
 Website Technical Director  
[john@texasturner.com](mailto:john@texasturner.com)

Dale Barrack-Website Creative Director  
 (281) 358-8529

Jim Keller—Board Member  
 (281) 467-2866  
[jimkeller.foxfire@comcast.net](mailto:jimkeller.foxfire@comcast.net)

David Morley—Newsletter Editor  
 (retiring)  
 (979) 255-8183  
[david.w.morley@gmail.com](mailto:david.w.morley@gmail.com)

Email: [gcwa@swbell.net](mailto:gcwa@swbell.net)  
GCWA Websites:  
[www.gulfcoastwoodturners.org](http://www.gulfcoastwoodturners.org)  
<http://jhanley.us>

Program Chairman  
**Tom Enloe**

Copyright 2008 GCWA

GCWA is affiliated with the American Association of Woodturners. GCWA meetings are usually held at 9:00 AM on the 3rd Saturday of each month. Check the Calendar of Events page. Annual dues are \$18 due on January 1. Dues may be mailed to Mack DeBose, 11535 Clover Lane Ct, Houston, TX, 77066-3816. Make your check payable to GCWA or Gulf Coast Woodturners Assn.

## Internet Web Sites of Interest

American Association of Woodturners: <http://www.woodturner.org>  
Robert Sorby: <http://www.robert-sorby.co.uk/turning.htm>  
Wood Magazine: <http://www.woodmagazine.com>  
Rockler: <http://www.rockler.com>  
The Cutting Edge: <http://www.cuttingedgetools.com>  
Craft Supply: <http://www.woodturnerscatalog.com>  
Tidewater Turners of Virginia: <http://www.esva.net/~woodturner>  
Fred Holder's More Woodturning: <http://www.fholder.com>  
Exotic Burl: <http://www.exoticburl.com>  
San Diego WoodTurning Center, Inc.: <http://www.sdwoodturning.com>  
Kestrel Creek Gallery: <http://www.kestrelcreek.com>  
Hibdon Hardwoods: <http://www.hibdonhardwood.com>  
Dallas Area Woodturners: <http://www.turningwood.com>  
Woodcraft: <http://www.woodcraft.com>  
Christian Burchard: <http://www.burchardstudio.com>  
Southwest Association of Turners: <http://www.texasturnortwo.com>  
Trent Bosch: <http://www.trentbosch.com>  
Central Texas Woodturners: <http://www.ctwa.org>  
Arizona Silhouette: <http://www.arizonasilhouette.com>  
The Wood Turning Center: <http://www.woodturningcenter.org>  
Woodturning Online: <http://www.woodturningonline.com>



Gulf Coast Woodturners  
Association