

Gulf Coast Woodturners Association

GULF COAST WOODTURNER

April, 2011



PRESIDENT'S CORNER

You are getting this newsletter a week earlier than usual because **our monthly meeting has been moved up a week to April 9th** in Richmond at Foxfire Studio. Our guest this month will be the renowned turner and educator, **John Jordan** of Cane Ridge, TN. John will be giving our morning demonstration on wood structure and how it relates to bowl turning. This demo is open to all interested individuals. In the afternoon John will give a more in-depth demonstration on turning hollow forms and their post-lathe decoration by carving and texturing. This afternoon class is \$25 per person, which is payable at the door. We have two hands-on workshops scheduled Sunday and Monday, also at Foxfire. The Sunday workshop will focus on turning hollow forms, and the tools that John uses to accomplish this task. The Monday workshop is designed to help you use carving and texturing in your own work. As always, these all day workshops are \$135 per person.

If you have not renewed your yearly membership, this is the last newsletter you will receive. Dues are \$25. Make your checks payable to GCWA, and get them to **Ed Peine** or **Jim Keller**, our Secretary and Treasurer. If your membership becomes inactive, you will lose the many perks of membership such as the newsletter, access to the website forum, the Gold Galleries, the DVD library, the Retreat, and the ability to show your work in the show-and-tell. We are an all-volunteer organization, and in addition to your dollars we need you to pitch in and help with the many, many little things that have to be done to make the club go. So please consider lending a hand and make this club get better every day.

Later in the newsletter (page 2) you will find candidate statements for those individuals standing for Officer and Board positions in the GCWA this year, and a ballot as a separate attachment for this election. The folks standing for the Officer and Past President positions are running unopposed, but feel free to write in your own name if you so desire. We have five excellent candidates for the four at-large Board positions. You can e-mail or snail-mail your ballots to **Ed Peine** (see the ballot), or you can bring it with you to the April meeting. We will have some extra ballots at the meeting for those of you who would lose your head if it wasn't bolted on (like me). Voting will be open until April 30, but don't delay or you will forget.

Also included in this newsletter is the class grid (page 9) and sign-up form (separate attachment) for the May Re-

GCWA Web Sites:
[Http://www.gulfcoastwoodturners.org](http://www.gulfcoastwoodturners.org)

treat. Registration for the Retreat will begin at the April meeting, first come-first served. This means a completed registration form, confirmation of your membership status and payment in full. All the details are discussed later in the newsletter. So I won't dwell on it. Something to keep in mind when you are looking at the class offerings is the level of skill listed with each class. I think many of us (me included) sometimes over-estimate our skill level, or perhaps we want to take a class that will challenge us to the maximum. However, if you are the intermediate turner in an advanced class, you are not doing any favors to the other students, the instructor or yourself. Please be honest with yourself. The retreat registration committee reserves the right to adjust student placement in classes.

The ballots have been counted, and the new **By-laws** have been resoundingly approved by a vote of 47 to 10. Thanks to all of you who helped in this mammoth task. We are now ready to prepare our submission to the IRS for the designation of a 501c3 nonprofit organization. The Board will report to you from time to time on the progress of this initiative. Any help from the membership on this is appreciated.

SWAT is coming up in August, which is not that far away. I have mentioned before that SWAT is looking for regional demonstrators. If you are interested, please contact George Hancock (ghancock@suddenlinkmail.com). They are also trying to put together a spouses program that would include a separate craft room, instant gallery, and tours of local sites such as the Homestead Heritage community. If your significant other is interested in helping with this effort, contact the SWAT vice-president **Janice Levi** and I'm sure she can point you in the right direction.

We will again be needing volunteers at **SWAT** to help with the room hosting duties. As usual, we will be taking care

Continued on page 2

**April Meeting
April 9, 2011**

Foxfire Studios

105 South 2nd St, Richmond, TX 77469

Continued from page 1

of a room for one of the lead demonstrators. You will remember that last year we hosted Molly Winton, who was delightful and very generous to the club for our help. This is a great way to learn about our A/V system (which we provide to SWAT) and get up-close and personal with world-renowned talent. Speak to me if you can help.

SWAT will also be supporting "Beads of Courage" this year. This is a program to provide small boxes to children with serious diseases, notably cancer. The kids use the boxes to store beads they have earned for attaining treatment goals during their therapy. For more information, please go to www.beadsofcourage.org. Anything we can do to help these children through one of the toughest times anyone can experience is a rewarding activity. Please help.

We will not have a formal show-and-tell at either the April or May meetings, due to the Jordan demo and the Retreat. This means there will not be judging of any work or

any photographs taken. This does not mean you can't bring in pieces for an informal instant gallery. In fact, we want you to bring work to Conroe for the Retreat, but not for judging. You can still bring these pieces back to a formal show-and-tell since they have not been entered in any judging.

I announced in March that we would like to have a club picnic in October. There has been total silence from the membership on the topic of a place to hold the picnic. If you know of someplace, or if you own a space big enough to hold us, please come forward and help us to get this organized.

See you at the Woodworking Show this weekend, and at John Jordan's demonstrations on the ninth.

Steve LeGue

Board Election: Candidate Statements

Reggie Keith for President:



volunteers to continue this tradition.

For me the mission statement of the Gulf Coast Woodturners Association can be described as Education, Encouragement and Entertainment. If elected President my goal will be to work with the board, other elected officers and the numerous

Don Fluker for Vice President:



As the Vice President I am not interested in having the largest club just the BEST and I will do my best to achieve that. I would appreciate your vote.

Ed Peine for Secretary:



Jan and I have resided in Houston all our lives. We are both retired. Turning has been a great hobby since '05. I joined the board in '09 and became secretary in '10. I get satisfaction turning large vessels and applying a good finish...but I take greater pleasure sharing turning ideas and spending time in the shop with fellow turners. If elected as your secretary, I commit to you to keep GCWA your club. So if you ever have any questions or concerns that you want addressed by the full board I will take your ideas to the board for its consideration.

Jim Keller for Treasurer



I would like to continue to serve GCWA as its Treasurer. I have been a member of GCWA and AAW since June 1991. I learned to turn with the help of GCWA members who were willing to share their knowledge and experience with me and I am eternally grateful. I am now a full time professional woodturner, selling my work in Galleries, at Art Festivals and from my Studio. I also teach, giving demos at various chapter meetings and symposiums as well as at my studio.

I have been a GCWA Mentor for many years. I prepared the GCWA draft budget for the past three years. I compiled the first draft of the proposed revised By-Laws for GCWA. I look forward to working to complete the registration of GCWA as a 501c3 corporation. This will open up the opportunity for GCWA to broaden our income through tax deductible contributions to support GCWA programs. I serve on the Boards of two 501c3 organizations.

GCWA faces challenges as does AAW in meeting the needs in brings value to the whole membership, which represents a wide range of turning skills and interests. I think one thing we can do is to have two demo or activities at our monthly meetings where the venue has the facilities. GCWA is a great organization, I have seen it grow in participation over the past twenty years from meetings with an attendance of a dozen people to the current lever of over seventy-five. I will appreciate your vote. Let's work together to continue to improve GCWA.

Continued on page 4

CLASSIFIED ADS

Woodturning related items of interest to GCWA Members listed as a free service.

Woodturning Lessons: Hands-on woodturning lessons are now being given by **Jim Keller** at Foxfire Studios. You pick the subject; learn with my tools or yours. Oneway 2430 and Jet 1642 lathes available. Rates- 4 hour lesson 4 hour lesson for GCWA Members \$70.00, non members \$80.00, add a second person for: member \$45.00, non-members \$50.00. Call 281-467-2866 for information or to schedule a lesson.

INSTRUCTION: Current woodturning instructor for the Houston Center for Contemporary Craft, **Thomas Irvén**, will teach beginning to advanced participants turning in his Bellaire Studio. Classes will be individualized to your needs and tools will be available. Learn box making multi-axis, spindle, and bowl turning and finishing. Limited to 1 - 4 students. Call or e-mail Tom for pricing and information. 713-666-6881. triven@sbcglobal.net.

PEN BLANKS FOR SALE...\$1.25 per blank plus shipping. Over 150 species available. Contact Doug Van Buskirk at dvb@comcast.net for a list of species.

FOR SALE: A Nova DVR 300 lathe with cast iron legs. Headstock pivots for outboard turning, one bed extension, vacuum adaptor and all the standard parts. Updated electronic controller. Asking \$1,400.00. Contact **Bob Tabor** @ bnbtabor1@suddenlink.net or 979-436-2283 (C)



Raffle at Spring Retreat

By Edward Bartimmo

The Spring Retreat is only a month away. Thanks to huge participation by key vendors this year's RAFFLE is GREAT!!! Hopefully, you have been squirreling away your cash. Time to go back and dig up that coffee can because here are some highlights that you will want to buy tickets and have a chance to win:

- Jet 1014I mini lathe

- Rockler dust collector

- Large hollowing system with laser by Lyle Jamieson
- Medium hollowing tool set by Trent Bosch
- Small hollowing tool set by David Ellsworth
- Micro hollowing tool sets by Sorby

- Circle cutting jig by Carter Products
- Bandsaw LogMill by Carter Products

- Bowl gouges by Thompson with custom turned handles
- Spindle gouges by Thompson with custom turned handles
- Bowl gouges by Henry Taylor
- Micro spindle tools by Sorby
- Easy Roughers
- Pyramid / Skewchigouge tools by Kendall Westbrook

- Wolverine sharpening system by Oneway

- Burnmaster pyrography set

- Bowl buffing system by Beall
- Bowl buffing system by Don Pencil

- Sanding Solution Tool by The Sanding Glove
- SandMaster by Sorby
- Sanding kits from Sanding Glove, Turning Wood, VinesWoodnWonders

- Calipers, finishes, glue, and other shop supplies
- Gift certificates – Craft Supply, Lee Valley Tools, Packard, Penn State

It is worth coming to the Spring Retreat just for the Raffle. I expect to see the same enthusiasm, support and participation in the Raffle by our members as we received from the vendors supporting our club.

Club News and Announcements

John Van Domelen

John's piece "Eye of the Storm" that won accolades at our show-and-tell back in 2009 was selected by *American Woodturner's* Members' Gallery in the 2011 April issue (see page 10). Congratulations, John.

Jerry Bennett and Andy Chen

Woodturning magazine (British) ran a short story on the segmented woodturning symposium held at the Arrowmont School of Arts and Crafts, Gatlinburg, TN, November, 2010 in the April, 2011 issue. Jerry was cited in the article and the picture of one of Andy's Corian bowls was shown. Congratulations, guys.

Tom Irvén for Director



I wish to help the GCWA with the quest of educating the public about woodturning and teaching those who are interested in the art and craft of woodturning. It is good to be able to give back to a club that provides so much to its members as well as the woodworking and woodturning communities. If re-elected, I will continue to support the issues that are in the best interests of our members and our club.

Lane Bradford for Director



Thank you for taking the time to read my little statement. I will be brief. I have been on the GCWA Board in the past, as Secretary for 6 years, then as Vice President for 2 years. I ran unopposed for my At Large position last year. So I know what I am getting myself in for.

Let me encourage you to VOTE. Vote for whoever you want to vote for, but be sure and VOTE. All the candidates are excellent, but it is discouraging to say that our wonderful GCWA with membership approaching 200 has had elections with fewer than 30 votes cast. If you absolutely don't like any of the candidates running, get your own candidate on the ballot. If you can't do that then be absolutely certain to tell whoever is elected how you feel about how this club is run, events you want to see, demonstrations you want to have and where you think we should have our next meeting. Any Board of Directors needs that information to be able to run the show.

Finally, I will be honored if you choose me again as your representative on the Board and THANKS for voting!

Ben Gray for Director:



I was introduced to a lathe when I was a teenager when dad bought a Rockwell lathe. I enjoyed just playing with it then but after a few years I just let it gather dust and never got into it again until I joined GCWA and learned what fun I had missed all those years. The GCWA is a catalyst for many of us that get inspired to go out and let our imaginations go wild. I now have 2 lathes, a bunch of tools and a messy garage. When I get out in the "studio", time and worries pass so fast. It is a great tranquilizer. I love to experiment with ideas and projects. A lot of my bowls turn into doughnuts but the ones that look good keep me loving this hobby.

I have been in sales for the majority of my working career and enjoy working with people. For that same reason, I have enjoyed the last 2 years on the board and would enjoy being on it for a while longer. I would appreciate your vote.

Tommy Joe for Director:



I, Tommy Joe have been a member of the GCWA for the pass ten years and a wood turner for over thirty years. But it was not until I came to the GCWA that the art and pleasure of wood turning began to blossom. It is this awakening that I would like to foster in others. I believe that the journey is as important as the destination and I would like to as a board member direct my energy toward exposing others to the GCWA and what this organization has to offer.

Edward Bartimmo for Director:



My name is Edward Bartimmo. I started turning almost 10 years ago, and like most I am a weekend hobbyist and self-taught turner. As one of the younger members of the club, I am frequently challenged with balancing work, family and free time ...not to mention the usual turning challenges of which tool to use, how to use it, and what piece of wood to make into a tooth pick.

The GCWA's success is measured by the skills of its members and its longevity extends beyond any specific member or faction. The club should be focused on educating its members and providing exposure to new avenues of creativity in woodturning. I am most interested in expanding the membership, especially drawing in younger turners. I am a believer in developing an active mentoring program to ensure that knowledge and skills aren't forgotten or lost. I would like to streamline the monthly meetings, specifically in duration, content, and guest demonstrators. I would also like to encourage the return of an informal monthly turning group.

Steve LeGrue for Immediate Past President:



It has been my honor to serve as President of GCWA for the past 2 years. As a member of this club since the late eighties, I have seen it grow from a few iconoclastic craftspeople into a large, dynamic organization that includes and encourages turners of all ages and skill levels. I hope that my last year on the Board of Directors will allow me to continue to serve the growth of the club through community outreach and education.

2011 Spring Retreat

By Douglas Grissom

When you receive this newsletter it will be 50 days or fewer to the 2011 Annual GCWA Spring Retreat and you have even fewer days to get your registration form into Ben Gray or Ed Peine.

Tom Enloe and Paula Haymond have corralled a tremendous line-up of instructors and demonstrations for you to participate in at the retreat.

Reggie Keith has been working hard to round up the necessary number of mini lathes and large format lathes needed to put on this event. He probably needs some more. So if you haven't volunteered your lathe, contact Reggie at reggie.keith@hoover-keith.com.

Ed Bartimmo has rounded up a stupendous amount of turning items for the raffle, so save up your money to buy some tickets. If you do not buy tickets, you can not win that new tool that you want.

A couple of short notes on the registration form. Number one is to print plainly so Ben and Ed can read it. Number two is to be very honest when you select your level of turning skills. Number three is to get your form in EARLY. Number four is to get your main chef to cook a bunch of whatever homemade goodies she or he does best!

If you have any questions you can contact me, Douglas Grissom at douglas.grissom@att.net or 281-844-4397(C). Looking forward to seeing all of you at the retreat.

GCWA Membership – Calendar Year Basis

By Steve LeGrue

There have been several recent questions pertaining to the GCWA Membership Fees. The club membership is \$25.00 per calendar year. All memberships expire at the same time each year – December 31st. Therefore, all memberships are due by January 1 of the new calendar year. We do not pro-rate renewing membership fees.

GCWA Membership is a family affair. It includes the named member, spouse / significant other and minor chil-

dren in the same household. Adult children are welcome to join with memberships of their own.

While membership is family based, participation in special events is not. For example anyone participating in classes at the annual Retreat is expected to pay a full event registration fee. The same would apply for Demo Days and Classes. Our monthly meetings are, of course, open to all club members, their family, friends, and guests.

Hopefully this clarifies the matter. However, if you have any questions please contact one of the board members by e-mail or phone.

Delicate Box with Finial with Janice Levi A GCWA Exclusive Hands-On Class

By Lane Bradford

Simply put, this was a class worth repeating and, or if, it's repeated you really need to be the first to sign up! Call George today and demand he asks Janice to repeat this class, or do other classes for us.

Janice uses the skills she developed as a teacher and the woodturning skills she was taught



by our own Luna Ford and Bill Berry to produce a flawless class for her students. She starts off with "visual aids" to demonstrate the "Golden Mean" and the proper size relationship of the components of the box you are going to

complete. Janice keeps it simple. We all made the exact same box so that eliminated individual variations in her instructions and sizing. She taught you the process and left you to experiment with your own artistic improvements in your own studio.

If, like me, you have never successfully attempted a delicate final, you will with Janice's guidance. Proportions of the components and symmetry are all important and Janice has the patience to guide you thru the pitfalls. While this is not a beginners level class it does have enough challenges to keep the attention of the advanced turner while really improving the understanding of proportions and tool handling for the intermediate turner.

By the way, for those of us who haven't given George Kabacinski a "Thank You!" for promoting and underwriting these hands-on classes with local talents, make sure you do that at your first opportunity.
(Photo by Bill Berry)

International Wood Collectors Society

By Doug Van Buskirk

Most woodturners are not only interested in creative turning they are also interested in the wood they turn. Surprisingly enough there is an organization that is involved with only that - wood and wood collecting. The International Wood Collectors Society has members who are interested in obtaining as many different species of wood as possible and doing something useful with it. Most members are turners and carvers but some are just collectors (collecting 'standard' specimens (1/2" x 3" x 6") of as many species as they can. One member, I now has a collection of 14,500 different species. Some members travel around the world in the quest of wood to add to their collection. The Society publishes a quarterly magazine and has regional groups around the country. Best of all, each year they have meetings in various locations

where they show their specimens and crafts and auction off wood. Of primary interest is the meeting I always go to in February near Ocala Florida. In addition to turning and carving demonstrations they hold an all day auction of various woods that individuals bring. The auction is a fund raiser for the Society and most members bring logs or boards of various sizes for auction. Some are as small as a few pen blanks and others are the size of huge tree trunks. There is a Woodmizer on site to cut anything to your specifications. The auction is fun and a great way to obtain new wood. (If you decide to participate you must be a member and it sure helps if you have a SUV or truck to bring home your wood.) This year I came home with 23 new species of wood....and I am not a beginner. The advantage of this meeting is the wood is relatively cheap and you have the opportunity to obtain wood that grows in backyards and the Everglades and is not commercially available. If you would like more information, look at the International Wood Collectors Society web site or contact me at DVB@Comcast.net.

The Empty Bowl Event

By Bill Lewis

On March 19, the Houston Food Bank and The Houston Center for Contemporary Craft hosted the annual Empty Bowl Event. This event sells bowls to the public for \$25.00 to raise funds for the Houston Food Bank. For this money, the buyer gets a bowl and a bowl of soup (not in the bowl they bought). GCWA has been participating for many years by demonstrating and collecting and supplying bowls for the event. The potters are also participants and have their demonstrators there as well. This year Greg Gon-



Dave Barziza takes a break



Greg Gonsalves and Don Fluker working away



Paula Haymond looks pretty serious

salves, Don Fluker, Dave Barziza and Bill Lewis set up tents and lathes and started making shavings. Paula Haymond also joined us. There was a lot of interest and some interesting shapes were turned. (I had to leave early afternoon so cannot comment on the participants in the afternoon.)

More on Local Classes

By Derek Powers

With the retreat class registration beginning, it provides an opportunity to bring awareness to a couple of other GCWA educational opportunities. Since George Kabacinski organized the local classes last fall, I've had the opportunity to participate in three of them.

Following his January demo of turning small hollow forms, Larry Zarra provided a day of hands-on instruction on the same topic in February at U of H. The highlights of the class involved planning vessel design, tool use, and critiques. We each left with a small hollow form turned using hand held tools. Larry put a lot of effort into the class, providing a handout as well as bringing examples of several vessels he has turned. He also brought in several books

he uses as inspiration for the vessels he creates. We've all seen that he has a real eye for form, so his critique session was very instructive.

The other classes I've taken were Paula Haymond's piercing class and Janice Levi's finial box class which were both excellent. These classes have been reviewed elsewhere, but a couple of similarities come to mind. First, everything was turned on a mini lathe. So these techniques apply to all of our members. Second, in all the classes, the instructors shared techniques they had learned from internationally known instructors. It made me realize what a value I was getting.

So if you're like me and can't possibly take all of the Retreat classes that you would like to, keep an eye on the newsletter. There may be an expanded version in a local class soon.

MARCH SHOW & TELL

Judges: Gene Bradley and Don Smith

Photos: Paul Millo

Advanced Category

1st Place – Clyde Collier



Natural edge avocado vase

2nd Place – Scott Njaa

Walnut bowl



3rd Place – Andy Chen



Ash plate

Intermediate Category

1st Place – Darrell Corcorran



Mesquite goblet set

2nd Place – Craig Nitsch



Mesquite hollow form

3rd Place – Ron Hedman



Box elder bowl

Beginner Category

1st Place – Noah Gilbert



Oak and padauk cup

1st Place – Dan Fleetwood

Pens



1st Place – Dan Fleetwood



Goblet

Enhanced Category

1st Place – Delbert Pond



Oak hollow form

2nd Place – Steve LeGrue



Maple bowl

Segmented Category

1st Place – Aaron Gilbert



Oak/Walnut/
Antler Stein

Judges



Snapshots from the March Meeting

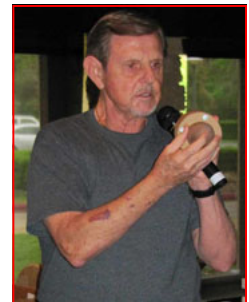
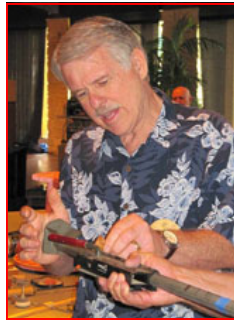
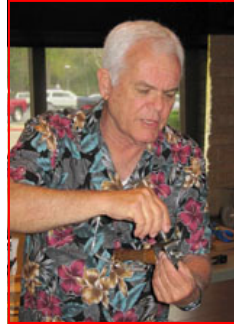

Pictures can be viewed at www.gulfcoastwoodturners.org
 Photos: Ric Taylor, Dale Barrack,

MENTOR PROGRAM

The following members have volunteered to serve as Club Mentors:

Jim Keller ----- (281) 467-2866

Larry Zarra ----- (281) 528-9183

By Reed ----- (979) 830-0917

Bill Berry ----- (281) 479-8073

Marty Kaminsky -- (281) 339-3297

Luna Ford ----- (281) 476-4159

Brian Laing ----- (281) 580-5381

Thomas Irven ---- (713) 661-6881

If you would like to have one of these individuals talk with you about a particular piece, feel free to bring it to the meeting.

2011 GCWA RETREAT

Time	Area A	Area B	Area C	Hands On Area D	Area E	Area F	Area G	Area H	Area I	Area J	Demo Area K	Outside Area L	Sharpening Area S		
SATURDAY, May 21															
Kick-off / Opening Remarks															
8:30 - 9:00	Color legend:			Advanced	Intermediate									Beginner	Open to all
9:00 - 10:30	Janice Levi = Banksia Pod box	By Reed = Platters	Andy Chen = Goblets	Ed Peine = Kaleidoscope & Free Use	Scott Njaa = Bowls	Larry Zarra = Delicate Boxes	Chris Roth = Bottle Stopper	Don Fluker = Acrylic Pens	Tom and Steve = Fundamentals of turning	Lane Bradford = Basic Bowls	Kendall Westbrook = Paintbooth Jay Ebner = Toolmaking	Greg and Fog = Chainsaw	Free Use		
10:30 - 12:00															
12:00 - 1:30	Lunch / Announcements														
1:30 - 3:00	Paula Haymond = Surface treatments	Fog Tanner = Raffan Bowls	Brian Laing = Finales	Free Use	John Gay = Small Bowls	Reggie Keith = Tool handles	Dennis Ford = Natural Bowl	George Kabacinski = Basic Pens	Steve and Tom = Fundamentals of turning	Luna Ford = Minitures	John King = bowls Finishing Q&A Panel	Open	Bill Berry = Sharpening		
3:00 - 4:30															
SUNDAY, May 22															
Lunch / Announcements															
8:30 - 10:00	Janice Levi = Banksia Pod box	By Reed = Platters	Andy Chen = Goblets	Ed Peine = Kaleidoscope & Free Use	Scott Njaa = Bowls	Dave Barziza = Bracelets	Chris Roth = Bottle Stopper	Don Fluker = Rifle Pens	Troy McLaughlin = Bottle Stoppers	Lane Bradford = Basic Bowls	Paula Haymond = Decorating Paula Haymond = Texturing	Greg and Fog = Chainsaw	Free Use		
10:00 - 11:30															
11:30 - 12:30	Lunch / Announcements														
12:30 - 2:00	Tom Irven = TBD	Fog Tanner = Raffan Bowls	Brian Laing = Finales	Free Use	John Gay = Small Bowls	Reggie Keith = Tool handles	Dennis Ford = Natural Bowl	George Kabacinski = Basic Pens	Open	Luna Ford = Minitures	Gene Volentine = Texturing open	Open	Bill Berry = Sharpening		
2:00 - 3:30															
3:30 - 5:00	Every one - CLEAN-UP, raffle and closing														

Reprinted from American Woodturner, April, 2011 with permission

Members' Gallery



Johnny Taylor

"This piece represents the entrance or portal to the other world or afterlife, as believed by cultures long gone. The suspended ring represents the portal and the carved lines on the stand represent water, where ancient European cultures believed entrances to the spirit world lay. The inscription warns: death awaits."

—Johnny Taylor

Entrance to the Other World, 2010, English oak, sycamore, acrylic paint, leather, 21" x 28" x 6" (53 cm x 71 cm x 15 cm)

John Van Domelen

"I was an artist-in-residence at the Houston Center for Contemporary Craft (craft-houston.org) at the time of Hurricane Ike. *Eye of the Storm* was one of the first pieces I turned from the huge amount of timber available on Galveston Island and surrounding area after the storm swept through Texas. I needed to regroup myself and to connect with the positive cycle of renewal, so I created a series titled Gifts from Ike from the salvaged wood.

I had never turned a piece this large before and I was intimidated. Larry Zarra and Jerry Bennett from the Gulf Coast Woodturners AAW chapter suggested that I get over my fear and *just do it!* Thanks, guys."

—John Van Domelen, texasturner.com

Eye of the Storm, 2008, Pecan, 26" dia. (66 cm)

Collection of the Galveston Historical Foundation, Lost Galveston Collection, Customs House, galvestonhistory.org

Photo courtesy of Bogan Gallery, Houston



Scheduled Meetings & Events

Meeting dates and locations are subject to change.

April 9, 2011 ~ GCWA General Meeting ~ 9:00 AM - noon

Location: Foxfire Studio, demonstrator, John Jordan

May 9, 2011 ~ Board meeting, Ed Peine's home

May 21, 22, 2011 ~ Spring Retreat

Location: Montgomery County Fairgrounds

June-2, 2011 ~ Board meeting

June 18, 2011 ~ GCWA General Meeting ~ 9:00 AM - noon

Location: Bayland Community Center, Houston, TX

June 24 - 26 ~ AAW national symposium

Location: St Paul RiverCenter, St Paul, MN

July 5, 2011 ~ Board meeting

July 16, 2011 ~ GCWA General Meeting ~ 9:00 AM - noon

Location: Memorial Drive Presbyterian Church

July 23, 2011 ~ Hands-on class, *Skew Techniques* by Fog Tanner, Cypress (registration open)

August 8, 2011 ~ Board meeting

August 20, 2011 ~ GCWA General Meeting ~ 9:00 AM - noon

Location: Bayland Community Center, Houston, TX

August 26 - 28, 2011 ~ SWAT annual symposium

Location: Waco Convention Center

April Meeting

Foxfire Studio

105 South 2nd street, Richmond, TX 77469

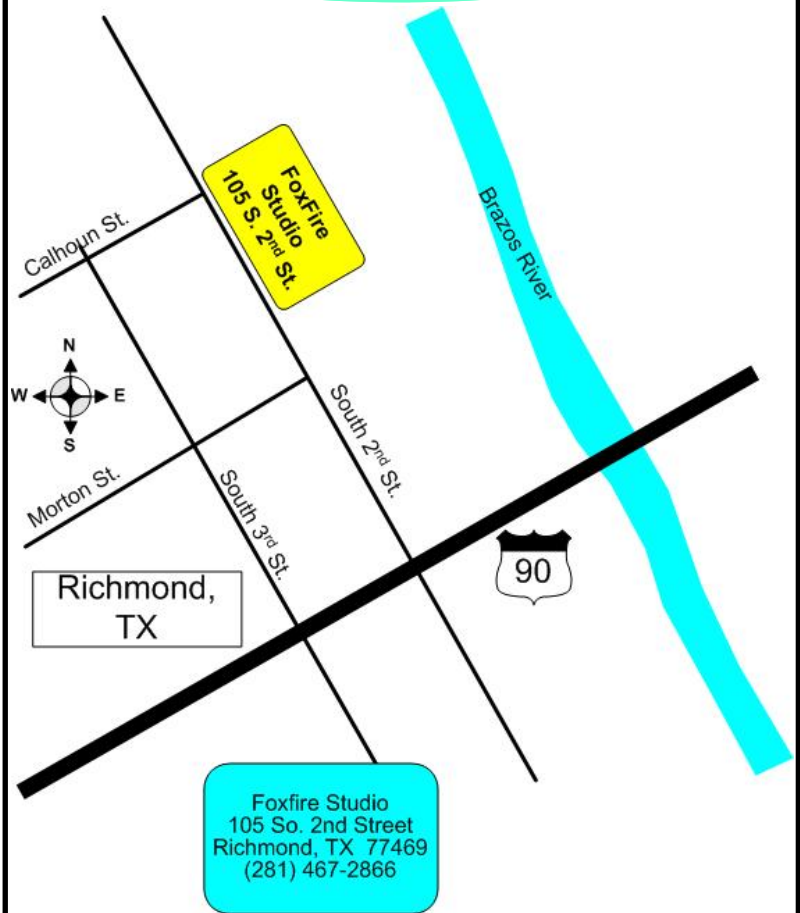

April Meeting Program

John Jordan demonstration

EXECUTIVE COMMITTEE

Steve LeGrue - President
(832) 496-0040 cell
slegrue@comcast.net

**Dave Barziza - Vice President/
Judging**
(713) 661-5941
davebarziza@yahoo.com

Ed Peine - Secretary
(713) 977-9922
epeine@comcast.net

Jim Keller - Treasurer
(281) 467-2866
jimkeller.foxfire@comcast.net

Lane Bradford - Board Member
(936) 447-9310
LaneBradford@eaton.com

Derek Powers - Board Member
(832) 444-2470
derekpowers@gmail.com

Thomas Irvén - Board Member
(713) 666-6881
trirven@sbcglobal.net

Ben Gray - Board Member
(281) 859-3132
BenG@rigidbuilding.com

Chris Roth - Board Member
(713) 444-5619
rothcf@earthlink.net

Dale Barrack-Website Creative Director
(281) 358-8529

John Van Domelen - Website Technical Director
john@texasturner.com

Andy Chen - Newsletter Editor
(979) 693-1211
andy_c_chen@yahoo.com

Email: gcwa@swbell.net
GCWA Websites:
www.gulfcoastwoodturners.org

Program Chair
Tom Enloe

Copyright 2010 GCWA

GCWA is affiliated with the American Association of Woodturners. GCWA meetings are usually held at 9:00 AM on the 3rd Saturday of each month. Check the Calendar of Events page. Annual dues are \$25 due on January 1. Dues may be mailed to Jim Keller, 105 S. 2nd Street, Richmond, TX 77406. Make your check payable to GCWA or Gulf Coast Woodturners Assn.

Internet Web Sites of Interest

American Association of Woodturners: <http://www.woodturner.org>
Robert Sorby: <http://www.robert-sorby.co.uk/turning.htm>
Wood Magazine: <http://www.woodmagazine.com>
Rockler: <http://www.rockler.com>
Craft Supply: <http://www.woodturnerscatalog.com>
Tidewater Turners of Virginia: <http://www.esva.net/~woodturner>
Fred Holder's More Woodturning: <http://www.fholder.com>
Exotic Burl: <http://www.exoticburl.com>
San Diego WoodTurning Center, Inc.: <http://www.sdwoodturning.com>
Kestrel Creek Gallery: <http://www.kestrelcreek.com>
Hibdon Hardwoods: <http://www.hibdonhardwood.com>
Dallas Area Woodturners: <http://www.turningwood.com>
Woodcraft: <http://www.woodcraft.com>
Christian Burchard: <http://www.burchardstudio.com>
Southwest Association of Turners: <http://www.swaturners.org>
Trent Bosch: <http://www.trentbosch.com>
Central Texas Woodturners: <http://www.ctwa.org>
Arizona Silhouette: <http://www.arizonasilhouette.com>
The Wood Turning Center: <http://www.woodturningcenter.org>
Woodturning Online: <http://www.woodturningonline.com>



**Gulf Coast Woodturners
Association**